

Easy Patch Quilt

Designed by Susan Laity Price



<i>Chenille By The Inch™</i>	
Color	Amount
Chenille color of choice (Almond shown)	800"
Other Materials	
Twin-size cotton batting	
Sewing thread to match fabric	
<i>Chenille Brush™</i> & <i>Chenille Cutting Guide™</i>	
Spray bottle with water	

Continuous Line Flower Pattern

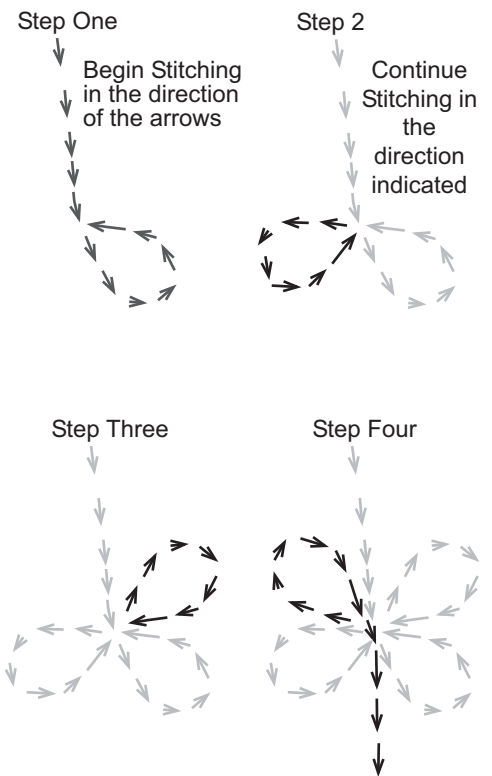

Add more flowers by repeated steps 1- 4



Fabric	Yardage	#of Pieces to Cut	Dimensions
Assorted Fabrics Block	2 3/4 yd. total	48	8 1/4" x 8 1/4"
Backing Fabric	3 yds.	2	54" x WOF

Finished Size: 46 1/2" x 62"

Step 1

Assemble quilt top by sewing eight rows of six blocks each, press seams open. Sew rows together, press seams open. For backing sew 54" x WOF pieces together along 54" side, press.

Step 2

Layering pieces in the following order and placing right sides of top and backing together, sandwich top, backing and batting, pin together and trim edges even with top. Leaving 12" opening for turning, sew layers together, turn, press. Hand stitch opening closed.

Step 3

Remove tear-away backing from *Chenille*

By The Inch®. Using the *Chenille Cutting Guide™*, and cutting between the stitched lines with a rotary cutter, cut into strips. Sew *Chenille By the Inch®* to seams, back tacking at beginning and end of each strip.

Step 4

Quilt as desired, or following suggested continuous line flower pattern, in each square being careful not to quilt over *Chenille By The Inch®*.

Step 5

Using a spray bottle with distilled water, dampen sewn *Chenille By The Inch®*; using a *Chenille Brush™*, brush vigorously to fluff chenille.

Fabric Café®

12973-C Hwy 155 S, Tyler, Texas 75703 (903) 509-5999

© Fabric Café 2005